

AIR/WATER/SUCTION CHANNEL CLEANING ADAPTER MODEL OF-B153 for PENTAX G-I Endoscopes

1. INTENDED USE

In lieu of the standard rubber adapter OF-B115/166, the metal Air/Water/Suction Channel Cleaning Adapter, Model OF-B153, can be attached to the air/water cylinders and suction cylinders of PENTAX G-I Endoscopes for cleaning and high-level disinfection of the air/water/suction channels. This adapter caps (seals) off the air/water and suction cylinders to allow unidirectional flow of solution through these delivery/aspiration systems. NEVER use this channel cleaning adapter for any other purpose other than that for which it has been designed. Prior to use, the OF-B153 should be inspected.

2. APPEARANCE

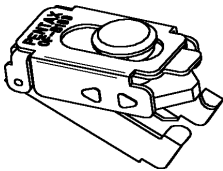

3. DIRECTIONS FOR USE

Read the following directions carefully, and refer to the figures right above.

- ① Raise the locking cap and slide the side covers (marked with \triangle) downward.
- ② Align the cylinder guide with the air/water and suction cylinder inlet.
- ③ Slide the OF-B153 forward.
- ④ Holding the side covers (marked with \triangle), push down and slide the locking cap under the locking tab to secure.
- ⑤ Lock the locking cap with the locking tab of the base.

NOTE:

It is imperative that the OF-B153 channel cleaning adapter be securely attached to the valve cylinders. Failure to properly secure the cleaning adapter could result in ineffective and incomplete reprocessing.

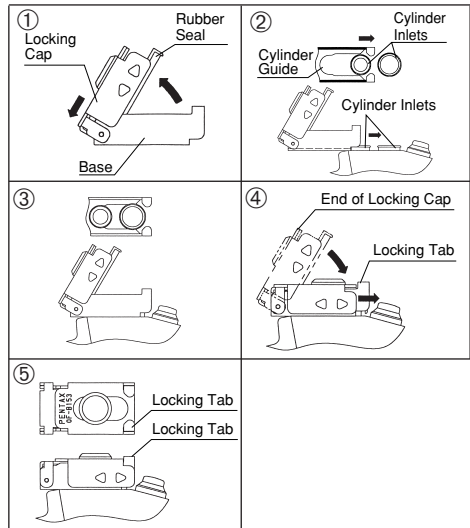

4. CARE AFTER USE

Refer to the manual supplied with the PENTAX Endoscope.

WARNING:

During reprocessing, splashing, splatter and exposure to patient fluids and/or reprocessing chemicals might occur. Always wear personal protective equipment including but not limited to gloves, gowns, facemasks, etc. to minimize the risk of cross contamination.

PENTAX™

HOYA Corporation

2-7-5 Naka-Ochiai, Shinjuku-ku, Tokyo 161-8525 Japan

HOYA Corporation PENTAX Life Care Tokyo Office

3-16-3 Higashi-Ikebukuro, Toshima-ku, Tokyo 170-0013 Japan
Tel : (03) 5953-2592 Fax : (03) 5953-2595

PENTAX Europe GmbH

Julius Vosseler Strasse 104,
22527 Hamburg, Germany
Tel : 040-561-920
Fax : 040-560-4213



(Authorised Representative
in the European Union)

PENTAX Medical Company

A Division of PENTAX of America, inc.

102 Chestnut Ridge Road Montvale, New Jersey 07645-1856
Tel : 201-571-2300 Fax : 201-391-4189
Toll Free : (800) 431-5880

85806

2009. 11 6217001 Z733 R06

