



The guarantee of your protection will be only ensured after the erlab<sup>®</sup> laboratory approval. Please contact your supplier and benefit from the ESP<sup>®</sup> (Erlab Safety Program) for a validation of the safety parameters (type of column, filter lifetime, saturation detection method and replacement filter procedure...), linked to the use of this cabinet.

## Technical specifications

### Dimensions (mm)

Ref.	External dimensions		
	Width	Depth	Height
822	820	350	730

### Structure

<b>Metallic parts</b>	Anti-corrosion steel coated with 100% polyester
<b>Door</b>	Synthetic glass 8 mm
<b>Filtration module</b>	Injected polypropylene

### Specifications

<b>Number of filter</b>	2
<b>Number of fan</b>	1
<b>Processed air flow</b>	75 m <sup>3</sup> /h
<b>Storage capacity</b>	Around 48 liters
<b>Voltage / Frequency</b>	230V / 50 Hz
<b>Power consumption</b>	20 Watts
<b>Amperage absorbed</b>	0,1 amp.

### Types of filters available

<b>AS</b>	For storage with a predominance of organic vapors
<b>BE</b>	For storage with a predominance of organic vapors and acids
<b>F</b>	For formaldehyde vapours
<b>K</b>	For ammonia vapours
<b>HP</b>	HEPA H14 filter for powders storage

## Equipments

### Versions

<b>822 A</b>	To be placed on a work surface
<b>822 B</b>	On legs.
<b>822 C</b>	To be wallmounted
<b>822 D</b>	to be placed under bench

### Standard Equipments

<b>Lock</b>	For a securised access to chemicals
<b>Retention tray volume</b>	2 x 1 liter. Spill tray included
<b>Shelves</b>	2 shelves adjustable in height and 2 fixed.

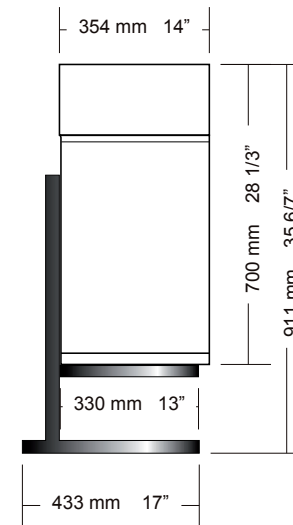
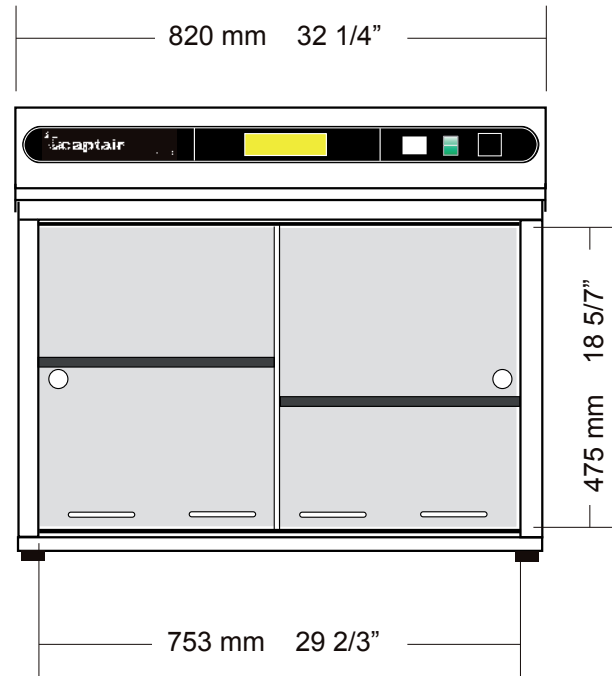
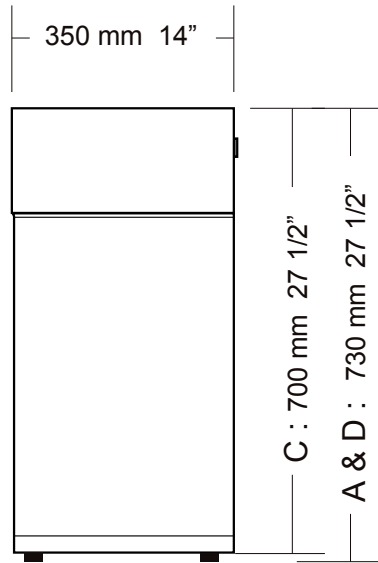

B Version

